

Teleflex cable conversion chart

OLD #		NEW#
CC633	=	CCX633
CC693	=	CCX433
CC692	=	CCX430
CC635	=	CCX179
CC694	=	CCX640
CC695	=	CCX643
CC172 (6'-9')	=	CCX633
CC636	=	CCX205
CC205 (6'-9')	=	CCX205
CC189 (6'-9')	=	CCX189
CC740	=	CCX740
CC179 (6'-9')	=	CCX179

OLD#	Standard	Midrange	Premium
33C (5'-9')	---	---	CCX633
33C (10'-24')	CC172	CCX332	CCX633
33C (25'-50')	CC172	---	CCX633
33CS (ALL)	---	---	CCX633

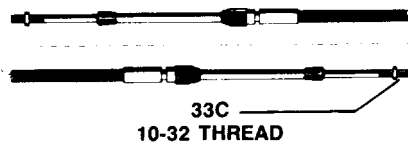

ISSUE DATE OCT-09
DATA SHEET NO USA-C1

AT A GLANCE

FEATURES

- TFXtreme's unique design incorporates a patent-pending splined core which allows easy movement and minimum lost motion
- Designed for complex and/or long cable runs (or to simply create a superior feel)
- Available in several style options avoiding the need for adaptor kits
- All TFXtreme cables are available in 1ft increments
- Gen II type suits Mercury 4000 series controls



Cross section view

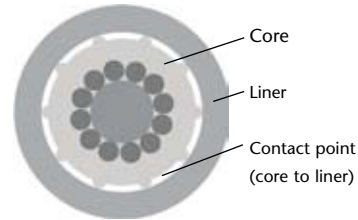

TFXTREME ENGINE CONTROL CABLES

TECHNICAL DATA

With it's unique splined core TFXtreme delivers unparalleled smoothness and efficiency - with hardly any lost motion - even in the longest and most complex cable routings. This gives superior feel at the control, performance that until now was considered 'impossible'.

ORDER INFORMATION

	CCX633XX
3300/33C (with 10-32 Treaded End 3" Travel)	
	CCX179XX
Mercury/Mercruiser	
	CCX630XX
(3600) 10-32 Control End Mercury, Mercruiser Engine End	
	CCX189XX
Mercury/Mercruiser Gen II	
	CCX205XX
Johnson/Evinrude/OMC	
	CCX430XX
(CC692XX and CC693XX are both 4300 Series cables with 1/4 - 28 Ends 3" Travel)	
	CCX433XX
CC694XX and CC695XX are both 6400 Series cables with 5/16 - 24 Ends 4" Travel	
	CCX640XX
CC694XX and CC695XX are both 6400 Series cables with 5/16 - 24 Ends 4" Travel	
	CCX643XX
CC694XX and CC695XX are both 6400 Series cables with 5/16 - 24 Ends 4" Travel	

NOTE - XX =cable length in feet



33C - 3300 TYPE CONTROL CABLES

3300/33C type cables (10-32 end threads). Engines and connection kits that accept a 10-32 threaded end may require a connection kit from Teleflex or the engine manufacturer.

Standard grade - Black cable conduit color with brass ends. Stainless steel core with wire/brass fittings. For I/O's, inboards and outboards. 10/32 SAE threads. Nominal 3" travel with 6" minimum bend radius.

Midrange grade - Red conduit color with stainless ends. Stainless steel core with wire/brass fittings. For I/O's, inboards and outboards. 10/32 SAE threads. Nominal 3" travel with 6" minimum bend radius

Premium grade - Black conduit color with stainless ends. TFXtreme's unique design incorporates a patent-pending splined core which allows easy movement and minimum lost motion. Designed for complex and/or long cable runs (or to simply create a superior feel).

All TFXtreme cables are available in 1ft increments. Gen II type suits Mercury 4000 series controls. 3300/33C (with 10-32 Treaded End 3" Travel).

**** MORSE 33C & 33C SUPREME ARE BEING DISCONTINUED BY TELEFLEX, SEE CHART BELOW FOR YOUR REPLACEMENT OPTIONS ****

STANDARD ..	MIDRANGE ...	PREMIUM ..	FT	MIDRANGE	PREMIUM	STANDARD
---	---	TEL-CCX63305 ..\$ 43.99 J	5'	MOR33C05	TEL-CC63305	TEL-CC17205
---	---	TEL-CCX63306 ..\$ 45.49 J	6'	MOR33C06	TEL-CC63306	TEL-CC17206
---	---	TEL-CCX63307 ..\$ 46.99 J	7'	MOR33C07	TEL-CC63307	TEL-CC17207
---	---	TEL-CCX63308 ..\$ 48.49 J	8'	MOR33C08	TEL-CC63308	TEL-CC17208
---	---	TEL-CCX63309 ..\$ 49.99 J	9'	MOR33C09	TEL-CC63309	TEL-CC17209
TEL-CC17210 ..\$ 37.99 J	TEL-CCX33210 .. \$ 44.49 J	TEL-CCX63310 ..\$ 51.49 J	10'	MOR33C10	TEL-CC63310	TEL-CC17210
TEL-CC17211...\$ 39.49 J	TEL-CCX33211 .. \$ 45.49 J	TEL-CCX63311 ..\$ 52.99 J	11'	MOR33C11	TEL-CC63311	TEL-CC17211
TEL-CC17212 ..\$ 38.49 J	TEL-CCX33212 .. \$ 46.99 J	TEL-CCX63312 ..\$ 54.49 J	12'	MOR33C12	TEL-CC63312	TEL-CC17212
TEL-CC17213 ..\$ 39.99 J	TEL-CCX33213 .. \$ 47.99 J	TEL-CCX63313 ..\$ 55.49 J	13'	MOR33C13	TEL-CC63313	TEL-CC17213
TEL-CC17214 ..\$ 40.99 J	TEL-CCX33214 .. \$ 49.49 J	TEL-CCX63314 ..\$ 56.99 J	14'	MOR33C14	TEL-CC63314	TEL-CC17214
TEL-CC17215 ..\$ 41.99 J	TEL-CCX33215 .. \$ 50.49 J	TEL-CCX63315 ..\$ 58.49 J	15'	MOR33C15	TEL-CC63315	TEL-CC17215
TEL-CC17216 ..\$ 42.99 J	TEL-CCX33216 .. \$ 51.49 J	TEL-CCX63316 ..\$ 59.99 J	16'	MOR33C16	TEL-CC63316	TEL-CC17216
TEL-CC17217 ..\$ 43.49 J	TEL-CCX33217 .. \$ 52.49 J	TEL-CCX63317 ..\$ 61.49 J	17'	MOR33C17	TEL-CC63317	TEL-CC17217
TEL-CC17218 ..\$ 44.49 J	TEL-CCX33218 .. \$ 53.99 J	TEL-CCX63318 ..\$ 62.99 J	18'	MOR33C18	TEL-CC63318	TEL-CC17218
TEL-CC17219 ..\$ 45.49 J	TEL-CCX33219 .. \$ 56.49 J	TEL-CCX63319 ..\$ 63.99 J	19'	MOR33C19	TEL-CC63319	TEL-CC17219
TEL-CC17220 ..\$ 46.99 J	TEL-CCX33220 .. \$ 56.49 J	TEL-CCX63320 ..\$ 65.49 J	20'	MOR33C20	TEL-CC63320	TEL-CC17220
TEL-CC17221 ..\$ 49.49 J	TEL-CCX33221 .. \$ 57.49 J	TEL-CCX63321 ..\$ 66.99 J	21'	MOR33C21	TEL-CC63321	TEL-CC17221
TEL-CC17222 ..\$ 49.99 J	TEL-CCX33222 .. \$ 58.49 J	TEL-CCX63322 ..\$ 68.49 J	22'	MOR33C22	TEL-CC63322	TEL-CC17222
TEL-CC17223 ..\$ 50.99 J	TEL-CCX33223 .. \$ 58.99 J	TEL-CCX63323 ..\$ 69.99 J	23'	MOR33C23	TEL-CC63323	TEL-CC17223
TEL-CC17224 ..\$ 51.99 J	TEL-CCX33224 .. \$ 59.99 J	TEL-CCX63324 ..\$ 71.49 J	24'	MOR33C24	TEL-CC63324	TEL-CC17224
...	...	TEL-CCX63325 ..\$ 77.99 J	25'	MOR33C25	TEL-CC63325	TEL-CC17225
...	...	TEL-CCX63326 ..\$ 80.99 J	26'	MOR33C26	TEL-CC63326	TEL-CC17226
...	...	TEL-CCX63328 ..\$ 86.99 J	28'	MOR33C28	TEL-CC63328	TEL-CC17228
...	...	TEL-CCX63330 ..\$ 92.99 J	30'	MOR33C30	TEL-CC63330	TEL-CC17230
...	...	TEL-CCX63334 ..\$ 126.49 J	34'	MOR33C34	TEL-CC63334	TEL-CC17234
...	...	TEL-CCX63336 ..\$ 139.49 J	36'	MOR33C36	TEL-CC63336	TEL-CC17236
...	...	TEL-CCX63340 ..\$ 165.49 J	40'	MOR33C40	TEL-CC63340	TEL-CC17240
...	...	TEL-CCX63346 ..\$ 204.49 J	46'	MOR33C46	TEL-CC63346	TEL-CC17246
...	...	TEL-CCX63348 ..\$ 217.49 J	48'	MOR33C48	TEL-CC63348	TEL-CC17248
...	...	TEL-CCX63350 ..\$ 230.49 J	50'	MOR33C50	TEL-CC63350	TEL-CC17250
...	...	TEL-CCX63354 ..\$ 260.49 J	54'	MOR33C54	TEL-CC63354	TEL-CC17254
...	...	TEL-CCX63356 ..\$ 268.99 J	56'	MOR33C56	TEL-CC63356	TEL-CC17256

TELEFLEX TFXTREME CONTROL CABLES

TFXtreme's unique design incorporates a patent-pending splined core which allows easy movement and minimum lost motion. Designed for complex and/or long cable runs (or to simply create a superior feel). 4300 Series cables with 1/4 - 28 Ends) 3" Travel.

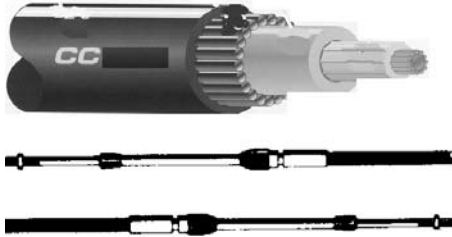

NEW PART#	OLD PART#			
TEL-CCX43307	CC693	4300 SERIES	7'	\$ 92.99
TEL-CCX43308	CC693	4300CC-TYPE	8'	\$ 95.49
TEL-CCX43309	CC693	4300CC-TYPE	9'	\$ 98.99
TEL-CCX43310	CC693	4300CC-TYPE	10'	\$ 99.99
TEL-CCX43311	CC693	4300CC-TYPE	11'	\$ 99.99
TEL-CCX43312	CC693	4300CC-TYPE	12'	\$ 104.99
TEL-CCX43313	CC693	4300CC-TYPE	13'	\$ 107.99
TEL-CCX43314	CC693	4300CC-TYPE	14'	\$ 112.99
TEL-CCX43315	CC693	4300CC-TYPE	15'	\$ 112.99
TEL-CCX43316	CC693	4300CC-TYPE	16'	\$ 114.99
TEL-CCX43317	CC693	4300CC-TYPE	17'	\$ 117.99
TEL-CCX43318	CC693	4300CC-TYPE	18'	\$ 119.99
TEL-CCX43319	CC693	4300CC-TYPE	19'	\$ 122.99
TEL-CCX43320	CC693	4300CC-TYPE	20'	\$ 122.99
TEL-CCX43321	CC693	4300CC-TYPE	21'	\$ 127.99
TEL-CCX43322	CC693	4300CC-TYPE	22'	\$ 132.99

TELEFLEX TFXTREME CONTROL CABLES

TFXtreme's unique design incorporates a patent-pending splined core which allows easy movement and minimum lost motion. Designed for complex and/or long cable runs (or to simply create a superior feel). 4300 Series cables with 1/4 - 28 Ends) 3" Travel. Bulk head fitting.

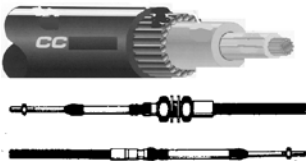

NEW PART#	OLD PART#			
TEL-CCX43006	CC692	4300BC-TYPE	6'	\$ 99.99
TEL-CCX43007	CC692	4300BC-TYPE	7'	\$ 99.99
TEL-CCX43008	CC692	4300BC-TYPE	8'	\$ 99.99
TEL-CCX43009	CC692	4300BC-TYPE	9'	\$ 104.99
TEL-CCX43010	CC692	4300BC-TYPE	10'	\$ 107.99
TEL-CCX43011	CC692	4300BC-TYPE	11'	\$ 109.99
TEL-CCX43012	CC692	4300BC-TYPE	12'	\$ 112.99
TEL-CCX43013	CC692	4300BC-TYPE	13'	\$ 114.99
TEL-CCX43014	CC692	4300BC-TYPE	14'	\$ 117.99
TEL-CCX43015	CC692	4300BC-TYPE	15'	\$ 117.99
TEL-CCX43016	CC692	4300BC-TYPE	16'	\$ 122.99
TEL-CCX43017	CC692	4300BC-TYPE	17'	\$ 122.99
TEL-CCX43018	CC692	4300BC-TYPE	18'	\$ 127.99
TEL-CCX43019	CC692	4300BC-TYPE	19'	\$ 132.99
TEL-CCX43020	CC692	4300BC-TYPE	20'	\$ 132.99
TEL-CCX43021	CC692	4300BC-TYPE	21'	\$ 132.99
TEL-CCX43022	CC692	4300BC-TYPE	22'	\$ 137.99
TEL-CCX43023	CC692	4300BC-TYPE	23'	\$ 142.99
TEL-CCX43024	CC692	4300BC-TYPE	24'	\$ 144.99
TEL-CCX43025	CC692	4300BC-TYPE	25'	\$ 147.99
TEL-CCX43026	CC692	4300BC-TYPE	26'	\$ 149.99

TELEFLEX TFXTREME CONTROL CABLES

TFXtreme's unique design incorporates a patent-pending splined core which allows easy movement and minimum lost motion. Designed for complex and/or long cable runs (or to simply create a superior feel). Mercury/Mercruiser

NEW PART#	OLD PART#				
TEL-CCX17906	CC635	MERC TYPE 600A KM	6'\$	54.49 J
TEL-CCX17907	CC635	MERC TYPE 600A KM	7'\$	56.99 J
TEL-CCX17908	CC635	MERC TYPE 600A KM	8'\$	62.49 J
TEL-CCX17909	CC635	MERC TYPE 600A KM	9'\$	65.99 J
TEL-CCX17910	CC635	MERC TYPE 600A KM	10'\$	67.99 J
TEL-CCX17911	CC635	MERC TYPE 600A KM	11'\$	69.99 J
TEL-CCX17912	CC635	MERC TYPE 600A KM	12'\$	71.49 J
TEL-CCX17913	CC635	MERC TYPE 600A KM	13'\$	73.99 J
TEL-CCX17914	CC635	MERC TYPE 600A KM	14'\$	75.49 J
TEL-CCX17915	CC635	MERC TYPE 600A KM	15'\$	78.99 J
TEL-CCX17916	CC635	MERC TYPE 600A KM	16'\$	79.49 J
TEL-CCX17917	CC635	MERC TYPE 600A KM	17'\$	81.49 J
TEL-CCX17918	CC635	MERC TYPE 600A KM	18'\$	83.49 J
TEL-CCX17919	CC635	MERC TYPE 600A KM	19'\$	85.49 J
TEL-CCX17920	CC635	MERC TYPE 600A KM	20'\$	86.99 J
TEL-CCX17921	CC635	MERC TYPE 600A KM	21'\$	90.49 J
TEL-CCX17922	CC635	MERC TYPE 600A KM	22'\$	90.99 J
TEL-CCX17923	CC635	MERC TYPE 600A KM	23'\$	93.49 J
TEL-CCX17924	CC635	MERC TYPE 600A KM	24'\$	94.99 J
TEL-CCX17925	CC635	MERC TYPE 600A KM	25'\$	107.99 J
TEL-CCX17926	CC635	MERC TYPE 600A KM	26'\$	109.99 J
TEL-CCX17927	CC635	MERC TYPE 600A KM	27'\$	109.99 J
TEL-CCX17928	CC635	MERC TYPE 600A KM	28'\$	112.99 J
TEL-CCX17929	CC635	MERC TYPE 600A KM	29'\$	114.99 J
TEL-CCX17930	CC635	MERC TYPE 600A KM	30'\$	114.99 J

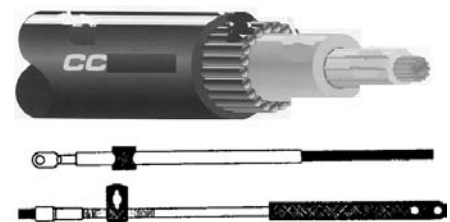

TELEFLEX TFXTREME CONTROL CABLES

TFXtreme's unique design incorporates a patent-pending splined core which allows easy movement and minimum lost motion. Designed for complex and/or long cable runs (or to simply create a superior feel). 6400 Series cables with 5/16 - 24 Ends) 4" Travel. Bulk head fitting.

NEW PART#	OLD PART#				
TEL-CCX64013	CC694	6400BC-TYPE	13'\$	219.99
TEL-CCX64014	CC694	6400BC-TYPE	14'\$	224.99
TEL-CCX64015	CC694	6400BC-TYPE	15'\$	227.99
TEL-CCX64016	CC694	6400BC-TYPE	16'\$	229.99
TEL-CCX64017	CC694	6400BC-TYPE	17'\$	234.99
TEL-CCX64018	CC694	6400BC-TYPE	18'\$	239.99
TEL-CCX64019	CC694	6400BC-TYPE	19'\$	244.99
TEL-CCX64020	CC694	6400BC-TYPE	20'\$	242.99
TEL-CCX64021	CC694	6400BC-TYPE	21'\$	252.99
TEL-CCX64022	CC694	6400BC-TYPE	22'\$	254.99

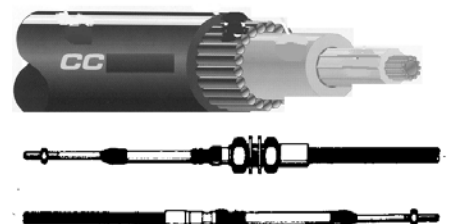

TELEFLEX TFXTREME CONTROL CABLES

TFXtreme's unique design incorporates a patent-pending splined core which allows easy movement and minimum lost motion. Designed for complex and/or long cable runs (or to simply create a superior feel). 6400 Series cables with 5/16 - 24 Ends) 4" Travel

NEW PART#	OLD PART#				
TEL-CCX64316	CC695	6400CC-TYPE	16'\$	214.99
TEL-CCX64317	CC695	6400CC-TYPE	17'\$	219.99
TEL-CCX64318	CC695	6400CC-TYPE	18'\$	224.99
TEL-CCX64319	CC695	6400CC-TYPE	19'\$	229.99
TEL-CCX64320	CC695	6400CC-TYPE	20'\$	227.99
TEL-CCX64321	CC695	6400CC-TYPE	21'\$	237.99

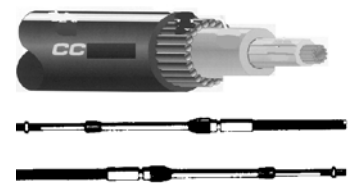

CONTROLS / CABLES

TELEFLEX OMC 479 TYPE "OS" PREMIUM CONTROL CABLE

OMC type 479, Complete drop in replacement cable for Johnson/Evinrude O/B and OMC I/O's (1979 and later). Stainless steel and brass fittings. Exceeds engine manufacturer's specifications. 6" minimum bend radius.

OMC 479 type Cable (1979 & Later)

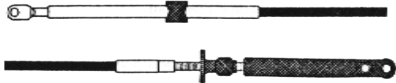

NEW PART#	OLD PART#				
TEL-CCX20510	CC636	OMC TYPE 479 (1979 & UP)	10' ...	\$ 67.99	J
TEL-CCX20511	CC636	OMC TYPE 479 (1979 & UP)	11' ...	\$ 69.99	J
TEL-CCX20512	CC636	OMC TYPE 479 (1979 & UP)	12' ...	\$ 71.49	J
TEL-CCX20513	CC636	OMC TYPE 479 (1979 & UP)	13' ...	\$ 73.99	J
TEL-CCX20514	CC636	OMC TYPE 479 (1979 & UP)	14' ...	\$ 75.49	J
TEL-CCX20515	CC636	OMC TYPE 479 (1979 & UP)	15' ...	\$ 78.99	J
TEL-CCX20516	CC636	OMC TYPE 479 (1979 & UP)	16' ...	\$ 79.49	J
TEL-CCX20517	CC636	OMC TYPE 479 (1979 & UP)	17' ...	\$ 81.49	J
TEL-CCX20518	CC636	OMC TYPE 479 (1979 & UP)	18' ...	\$ 83.49	J
TEL-CCX20519	CC636	OMC TYPE 479 (1979 & UP)	19' ...	\$ 85.49	J
TEL-CCX20520	CC636	OMC TYPE 479 (1979 & UP)	20' ...	\$ 86.99	J

UFLEX MACH-ZERO 33C TYPE CABLE

Suitable for outboard & inboard and sterndrive engines. High efficiency for smooth operation High flexibility for reduced bend radius. Ideal for long complex cable routings Maintenance free Stainless steel cables end fittings. High resistance blue outer jacket protects against abrasion, UV and chemicals.



UFL-MC0-06	6'	33C ULTRAFLEX CABLE BLUE	\$ 33.95
UFL-MC0-07	7'	33C ULTRAFLEX CABLE BLUE	\$ 36.45
UFL-MC0-08	8'	33C ULTRAFLEX CABLE BLUE	\$ 38.45
UFL-MC0-09	9'	33C ULTRAFLEX CABLE BLUE	\$ 40.45
UFL-MC0-10	10'	33C ULTRAFLEX CABLE BLUE	\$ 42.95
UFL-MC0-11	11'	33C ULTRAFLEX CABLE BLUE	\$ 44.95
UFL-MC0-12	12'	33C ULTRAFLEX CABLE BLUE	\$ 47.45
UFL-MC0-13	13'	33C ULTRAFLEX CABLE BLUE	\$ 49.45
UFL-MC0-14	14'	33C ULTRAFLEX CABLE BLUE	\$ 51.95
UFL-MC0-15	15'	33C ULTRAFLEX CABLE BLUE	\$ 53.95
UFL-MC0-16	16'	33C ULTRAFLEX CABLE BLUE	\$ 55.95
UFL-MC0-17	17'	33C ULTRAFLEX CABLE BLUE	\$ 58.45
UFL-MC0-18	18'	33C ULTRAFLEX CABLE BLUE	\$ 60.45
UFL-MC0-19	19'	33C ULTRAFLEX CABLE BLUE	\$ 62.95
UFL-MC0-20	20'	33C ULTRAFLEX CABLE BLUE	\$ 64.95

UFLEX MACH14

Stroke: 3" (75 mm) For Johnson®, Evinrude®, OMC® engines manufactured from 1979 to date. Blue color jacket. High performance applications.



UFL-MC14-08	8'	MACH 14 CONTROL CABLE	\$ 56.45
UFL-MC14-09	9'	MACH 14 CONTROL CABLE	\$ 58.45
UFL-MC14-10	10'	MACH 14 CONTROL CABLE	\$ 60.45
UFL-MC14-11	11'	MACH 14 CONTROL CABLE	\$ 62.45

TELEFLEX OMC 400 TYPE "O" CONTROL CABLE

Replacement shift & throttle cables for Evinrude, Johnson & OMC 1978 & earlier. Stainless wire with brass fittings.

TEL-CC17009	9'	CABLE	\$ 31.49	J
TEL-CC17010	10'	CABLE	\$ 32.49	J
TEL-CC17011	11'	CABLE	\$ 33.49	J
TEL-CC17012	12'	CABLE	\$ 33.99	J
TEL-CC17013	13'	CABLE	\$ 34.99	J
TEL-CC17014	14'	CABLE	\$ 35.99	J
TEL-CC17015	15'	CABLE	\$ 36.99	J
TEL-CC17016	16'	CABLE	\$ 37.49	J
TEL-CC17017	17'	CABLE	\$ 38.49	J
TEL-CC17018	18'	CABLE	\$ 39.49	J
TEL-CC17019	19'	CABLE	\$ 40.49	J
TEL-CC17020	20'	CABLE	\$ 40.99	J

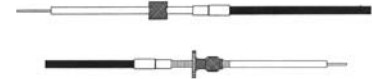

TELEFLEX OMC 479 TYPE OS CONTROL CABLE

OMC type 479. Complete drop in replacement cable for OMC O/B and I/O's (1979 and later). Stainless steel and brass fittings. Exceeds engine manufacturer's specifications. 6" minimum bend radius.

TEL-CCX20508	8'	CABLE PREMIUM CONTROL CABLE	\$ 31.49	J
TEL-CCX20509	9'	CABLE PREMIUM CONTROL CABLE	\$ 33.49	J
TEL-CC20510	10'	CABLE	\$ 32.99	J
TEL-CC20511	11'	CABLE	\$ 33.99	J
TEL-CC20512	12'	CABLE	\$ 34.49	J
TEL-CC20513	13'	CABLE	\$ 35.49	J
TEL-CC20514	14'	CABLE	\$ 36.49	J
TEL-CC20515	15'	CABLE	\$ 37.49	J
TEL-CC20516	16'	CABLE	\$ 37.99	J
TEL-CC20517	17'	CABLE	\$ 38.99	J
TEL-CC20518	18'	CABLE	\$ 39.99	J
TEL-CC20519	19'	CABLE	\$ 40.49	J
TEL-CC20520	20'	CABLE	\$ 41.49	J

OMC 479 type Cable (1979 & Later) P/N CC205XX

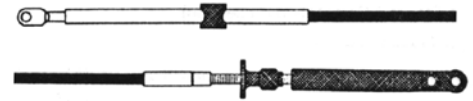

- ◆ Complete drop-in replacement cable for OMC O/B and I/O's (1979 & Later)
- ◆ Stainless steel and brass fittings
- ◆ Exceeds engine manufacturer's specifications
- ◆ 6" minimum bend radius

TELEFLEX MERCURY/MERCUISER 600A TYPE CABLE

Mercury/Mercruiser 600A type control cable. A complete drop in replacement cable for Mercury/Mercruiser and 1993 - date Force (U.S. Marine) engines. Stainless steel and brass fittings with stainless steel cable wire.

TEL-CCX17906	6'	CABLE	\$ 54.49	J
TEL-CCX17907	7'	CABLE	\$ 56.99	J
TEL-CCX17908	8'	CABLE	\$ 62.49	J
TEL-CCX17909	9'	CABLE	\$ 65.99	J
TEL-CC17910	10'	CABLE	\$ 30.99	J
TEL-CC17911	11'	CABLE	\$ 31.99	J
TEL-CC17912	12'	CABLE	\$ 33.49	J
TEL-CC17913	13'	CABLE	\$ 34.99	J
TEL-CC17914	14'	CABLE	\$ 36.49	J
TEL-CC17915	15'	CABLE	\$ 37.99	J
TEL-CC17916	16'	CABLE	\$ 38.99	J
TEL-CC17917	17'	CABLE	\$ 39.99	J
TEL-CC17918	18'	CABLE	\$ 40.99	J
TEL-CC17919	19'	CABLE	\$ 42.49	J
TEL-CC17920	20'	CABLE	\$ 43.49	J
TEL-CC17921	21'	CABLE	\$ 53.49	J
TEL-CC17922	22'	CABLE	\$ 54.99	J
TEL-CC17923	23'	CABLE	\$ 56.49	J
TEL-CC17924	24'	CABLE	\$ 57.99	J

Mercury/Mercruiser 600A type Cable P/N CC179XX

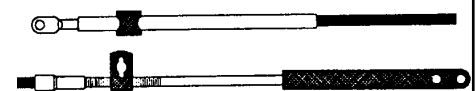

- ◆ Complete drop-in replacement cable for Mercury/Mercruiser and 1993-date Force (U.S. Marine) & Mariner engines
- ◆ Stainless steel and brass fittings
- ◆ Stainless steel cable wire

TELEFLEX MERCURY GEN II CONTROL CABLES

Designed specifically to be used with the new "Mercury 4000 Series Controls". Engineered to significantly reduce or eliminate cable "Wig-Wag". Improve the feel of the Mercury 4000 Series Controls.



TEL-CC18910	10'	GEN II MERC CONTROL CABLE	\$ 40.49	J
TEL-CC18911	11'	GEN II MERC CONTROL CABLE	\$ 40.99	J
TEL-CC18912	12'	GEN II MERC CONTROL CABLE	\$ 41.49	J
TEL-CC18913	13'	GEN II MERC CONTROL CABLE	\$ 42.49	J
TEL-CC18914	14'	GEN II MERC CONTROL CABLE	\$ 42.99	J
TEL-CC18915	15'	GEN II MERC CONTROL CABLE	\$ 43.99	J
TEL-CC18916	16'	GEN II MERC CONTROL CABLE	\$ 44.49	J
TEL-CC18917	17'	GEN II MERC CONTROL CABLE	\$ 45.49	J
TEL-CC18918	18'	GEN II MERC CONTROL CABLE	\$ 45.99	J
TEL-CC18919	19'	GEN II MERC CONTROL CABLE	\$ 46.99	J
TEL-CC18920	20'	GEN II MERC CONTROL CABLE	\$ 47.49	J

TELEFLEX MERCURY SPORT JET UP TO 120 H.P. & U.S. MARINE L-DRIVE

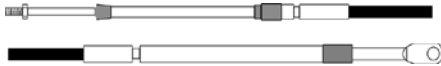

TEL-CC21312	12'	SHIFT CABLE	\$ 67.99
TEL-CC21313	13'	SHIFT CABLE	\$ 91.99
TEL-CC21314	14'	SHIFT CABLE	\$ 92.99
TEL-CC21315	15'	SHIFT CABLE	\$ 93.99
TEL-CC21316	16'	SHIFT CABLE	\$ 95.49
TEL-CC21317	17'	SHIFT CABLE	\$ 96.49
TEL-CC21318	18'	SHIFT CABLE	\$ 97.49
TEL-CC21319	19'	SHIFT CABLE	\$ 98.99
TEL-CC21320	20'	SHIFT CABLE	\$ 92.99

TELEFLEX OMC/VOLVO UNIVERSAL ENGINE END CABLE

OMC, Volvo Penta, Top Mount Control Cable. Black conduit color with brass and stainless ends.

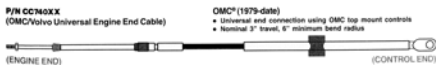

NEW PART#	OLD PART#			
TEL-CCX74012	CC740	12'	CABLE	\$ 61.49
TEL-CCX74013	CC740	13'	CABLE	\$ 62.49
TEL-CCX74014	CC740	14'	CABLE	\$ 63.49
TEL-CCX74015	CC740	15'	CABLE	\$ 63.99
TEL-CCX74016	CC740	16'	CABLE	\$ 64.99

43C TYPE CONTROL CABLES

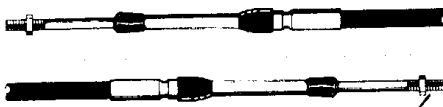

43C
1/4-28 THREAD

Part# 65885-003. Heavy duty shift and throttle cable with 3" travel and 1/4 - 28 SAE threads. 8" minimum bend radius. Recommended where heavy use or higher operating loads are encountered. For use on inboards and jets. Stainless steel armored core and end fittings. Note: In many instances, 33C Supreme cables can be used in place of 43C cables to improve control performance but you need to use 30 series cable connection hardware in place of 40 series.

MOR43C20	20'	43C CABLE	\$ 94.65	*
----------	-----	-----------	----------	---

43BC TYPE CONTROL CABLES

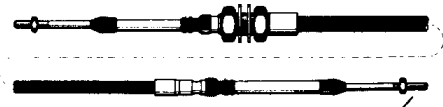

43BC
1/4-28 THREAD

Part # 46348. Heavy duty shift and throttle cables with 3" travel and 1/4 - 28 SAE threads. 8" minimum bend radius. Recommended where heavy use or higher operating loads are encountered. For use on jets. Stainless steel armored core and end fittings.

MOR43BC20	20'	43BC CABLE	\$ 99.41	*
-----------	-----	------------	----------	---

TELEFLEX MERCURY O/B AND I/O CONNECTION KIT

CA27319 connection kit for Mercury O/B and I/O only. For use with two 3300 cables.

TEL-CA27319P CONNECTION KIT\$ 20.99

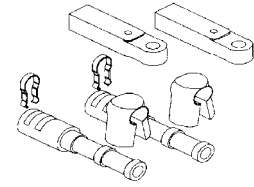

TELEFLEX OMC CONNECTION KIT

CA27320 connection kit for OMC only. For use with two 3300 cables.

TEL-CA27320P CONNECTION KIT\$ 20.99

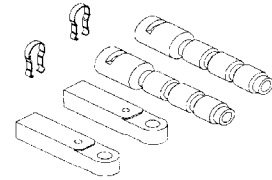

TELEFLEX PRE-1978 OMC, J/E CONNECTION KIT

CA27321 connection kit for pre-1978 OMC, Johnson and Evinrude. For use with two 3300 cables.

TEL-CA27321P CONNECTION KIT\$ 27.99

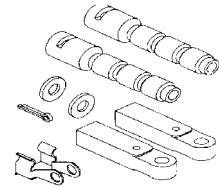

TELEFLEX JOHNSON/EVINRUDE 35HP AND LESS KIT

CA27208 connection kit for Johnson/Evinrude 35HP and below, 1973 - 1978. For use with 400 and 3400 cables.

TEL-CA27208P CONNECTION KIT\$ 55.49

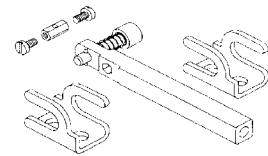

TELEFLEX JOHNSON/EVINRUDE 35HP+ KIT

CA27247=Connection kit for Johnson/Evinrude 35HP and up, 1973 - 1978. For use with 400 and 3400 cables.

TEL-CA27247P CONNECTION KIT\$ 20.99

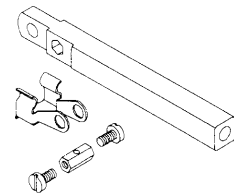

CABLE ADAPTER KITS

These kits are used to adapt 33C and 33C Supreme cables to fit directly to the existing engine connections.

300557=OMC Sterndrive

301729=Evinrude/Johnson 55 - 235HP 1978 to date. Evinrude/Johnson 20HP and up.

1986 20 - 25 - 30HP motors may need OMC kit #397488 if motor does not have it installed.

302123=Mer cruiser

301901=Mercury Outboards 40 - 300HP. For 18, 20, 25HP (1983 and earlier), Mercury part # 95722A1 also required.

For 18, 20, 25HP (1984 and later), Mercury part #95722A3 also required.

MOR300557	(A) OMC STERNDRIVE	\$ 10.49 *
MOR301729	(B) JOHNSON/EVINRUDE	\$ 26.49
MOR302123	(C) MERCURISER	\$ 18.49
MOR301901	(D) MERCURY OUTBOARDS	\$ 33.99

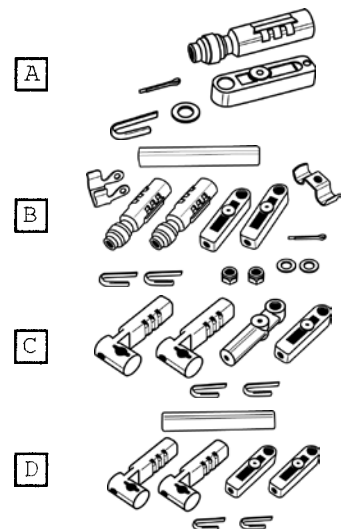

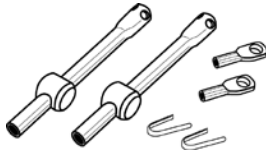

CONTROL ADAPTER KITS

These kits adapt 33C and 33C Supreme cables for use with other controls.

MOR301074	MERCURY/MARINER	\$ 71.99
MOR304939	OMC (1979 AND LATER)	\$ 106.99

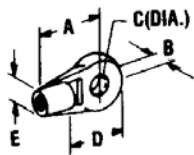

Part No.—
30 Series
31980

300646

31980
300646

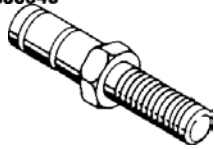

CONTROL CABLE TERMINAL EYE

	A	B	C	D	E	
MOR300646	1"	15/64"	5/16"	3/4"	1/2"	
MOR300646	30 SERIES RED PLASTIC					\$ 4.09

CONTROL CABLE TERMINAL EYE PIN

MOR301456	KIT (300965/RING/NUT/WASHER)	\$ 12.99
-----------	------------------------------------	----------

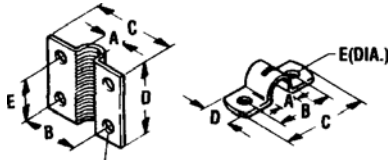

CONTROL CABLE CLAMPS

	A	B	C	D	E	F	
MOR37664	1/4"	1"	1 1/2"	1 1/4"	3/4"	7/32"	
MOR31509	3/8"	1"	1 1/2"	1/2"	12/64"		
MOR31532	1/2"	1"	1 1/2"	1/2"	7/32"		
MOR21227	1/2"	1"	1 1/2"	1 1/4"	3/4"	7/32"	
MOR36733	9/16"	1 1/4"	1 3/4"	5/8"	9/32"		
MOR37664	30L & 30 SERIES—NO HUB						\$ 5.39
MOR31509	30L & 30 SERIES						\$ 1.69
MOR31532	40 SERIES						\$ 2.69
MOR21227	40 SERIES						\$ 7.59
MOR36733	60 SERIES						\$ 3.79

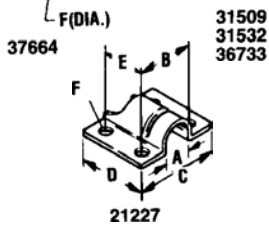

Shims

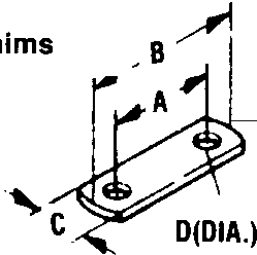

CONTROL CABLE SHIM

	A	B	C	D	
MOR35777	7/8"	1 3/8"	1/2"	12/64"	
MOR31538	1"	1 1/2"	1/2"	12/64"	
MOR37884	1 1/4"	1 3/4"	5/8"	9/32"	
MOR35777	SHIM				\$ 2.59
MOR31538	SHIM				\$ 1.39
MOR37884	SHIM				\$ 2.29

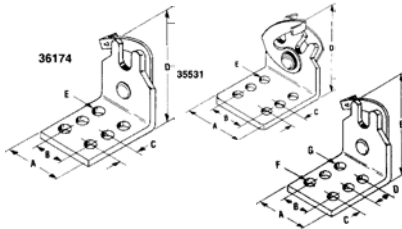

CONTROL CABLE HOOK CLIP

	A	B	C	D	E	F	G	
MOR36174	1"	1/2"	3/8"	1 1/2"	13/64"			
MOR35531	1 1/4"	3/4"	3/8"	1 1/2"	13/64"			
MOR31419	1"	1/2"	3/8"	1/2"	1 3/16"	1/4"	3/16"	
MOR36174	SINGLE							\$ 12.49
MOR35531	DOUBLE							\$ 31.49
MOR31419	30 SERIES ONLY							\$ 20.49

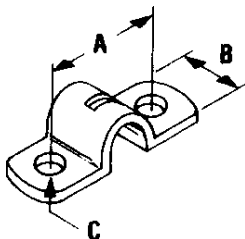

32010

CONTROL CABLE CLAMP

	A	B	C	
MOR32010	7/8"	1/2"	3/16"	
MOR32010	30 SERIES ONLY			\$ 4.29

CONTROL CABLE BRAKE

	A	B	C	
MOR44386	7/8"	1/2"	3/16"	
MOR44386	30/40/60 SERIES			\$ 22.99

CONTROL CABLE BALL JOINTS

	A	B	C	D	
MOR31126	31/32"	15/32"	9/16"	1/4-28"	
MOR31799001	29/32"	15/32"	7/16"	10-32"	
MOR35242	1 1/8"	17/32"	7/8"	5/16-24"	
MOR29104	31/32"	15/32"	9/16"	1/4-28"	
MOR32267	31/32"	17/32"	7/8"	5/16-24"	
MOR29108	1 1/8"	17/32"	7/8"	5/16-24"	
MOR31126	30 SERIES				\$ 13.99
MOR31799001	30 SERIES				\$ 14.49
MOR35242	30 SERIES				\$ 31.49
MOR29104	40 SERIES				\$ 13.49
MOR32267	40 SERIES				\$ 17.49
MOR29108	60 SERIES				\$ 27.49

CONTROL CABLE CLEVIS

	A	B	C	D	
MOR31125	2"	9/32"	1/4"	1 1/4"	
MOR31800	1 9/16"	3/16"	3/16"	1"	
MOR33395	2 1/4"	11/32"	5/16"	1 7/16"	
MOR42212	2 1/4"	11/32"	5/16"	1 7/16"	
MOR45985	2 1/2"	7/16"	5/8"	1 5/8"	
MOR29132001	2 1/4"	11/32"	5/16"	1 7/16"	
MOR31125	30 SERIES				\$ 15.49
MOR31800	30 SERIES				\$ 16.49
MOR33395	30 SERIES				\$ 18.99
MOR42212	40 SERIES				\$ 16.99
MOR45985	40 SERIES				\$ 26.49
MOR29132001	60 SERIES				\$ 17.99

CONTROL CABLE PIVOTS

	A	B	C	D	E	
MOR31029	1/4"	7/16"	21/64"	9/64"	5/8"	
MOR31539	1/4"	7/16"	3/8"	.191"	23/32"	
MOR32392	1/4"	7/16"	21/64"	.295	25.32"	
MOR37691	5/16"	7/16"	3/8"	13/32"	1 1/16"	
MOR39890	1/4"	7/16"	3/8"	.315"	15/16"	
MOR43939	1/4"	1/2"	3/8"	.376"	15/16"	
MOR31537	1/4"	1/2"	1/2"	13/64"	7/8"	
MOR36361	1/4"	1/2"	1/2"	17/64"	15/16"	
MOR39110	1/4"	1/2"	7/16"	9/54"	3/4"	
MOR31029	30 SERIES					\$ 10.99
MOR31539	30 SERIES					\$ 12.99
MOR32392	30 SERIES					\$ 12.99
MOR37691	30 SERIES					\$ 11.99
MOR39890	30 SERIES					\$ 17.49
MOR43939	30 SERIES					\$ 10.99
MOR31537	40 SERIES					\$ 11.99
MOR36361	40 SERIES					\$ 14.99
MOR39110	40 SERIES					\$ 12.49

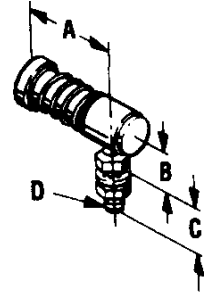
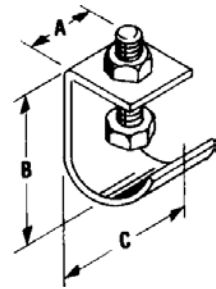

Type QR

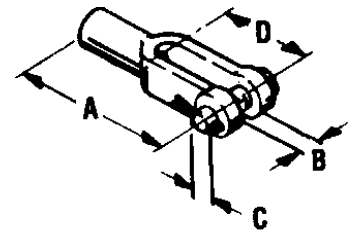

Clevis

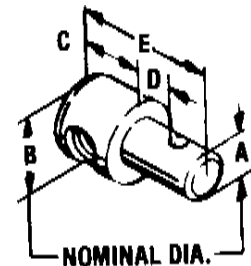

Pivots

KE-4 ELECTRONIC ENGINE CONTROL SYSTEM

New installation or retrofit - this control mates with any engine, inboard, outboard or stern drive; gas or diesel; our electronic control will replace cumbersome linkage, push-pull cables, hydraulic or pneumatic systems on pleasure boats and commercial craft alike. Features: Easy installation, fail safe operation, self-diagnosis system, control head with built-in station select switch, up to 3 stations, optional mechanical backup, gas or diesel engines, overload protection, single-lever dual function control, neutral warm-up provision.

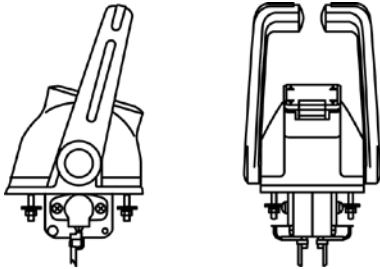

MOR-NM0414-33	KE-4 POWER HARNESS 10M.....	\$ 62.49	G
MOR-NM0511-00	KE-4 CONTROL SINGLE.....	\$ 488.49	G
MOR-NM0510-00	KE-4 CONTROL HEAD TWIN.....	\$ 598.49	G
MOR-NM0477-00	KE-4 CONTROL UNIT 12V.....	\$1452.99	G
MOR-NM0165-00	KE-4 ACTUATOR.....	\$ 804.99	G
MOR-NM0619-05	KE-4 COMM HARNESS 5M.....	\$ 64.49	G
MOR-NM0616-06	KE-4 CONTROL HARNESS 6M.....	\$ 80.99	G
MOR-NM0616-08	KE-4 CONTROL HARNESS 8M.....	\$ 85.49	G
MOR-NM0616-12	KE-4 CONTROL HARNESS 12M.....	\$ 94.99	G
MOR-NM0616-20	KE-4 CONTROL HARNESS 20M.....	\$ 134.99	G
MOR-NJ0514-00	KE-4 CIRCUIT BREAKER.....	\$ 63.49	G
MOR-NJ0596-00	KE-4 BUZZER 12V.....	\$ 21.39	G
MOR-NM0617-20	SW HARNESS 20M.....	\$ 78.49	G
MOR-NM0605-01	SYNC MASTER HARNESS.....	\$ 45.79	G
MOR-NM0605-02	SYNC SLAVE HARNESS.....	\$ 57.49	G
MOR-NJ0524-00	SYNC SWITCH KIT.....	\$ 110.49	G

MV-2 CONTROL FOR SKI/JET BOATS

A dual function, single lever control of both shift and throttle. Pullout clutch disengagement feature for warm up with neutral interlock to help prevent accidental shifting. Built in friction drag helps reduce throttle creep. Neutral safety switch prevents starting in gear. 2.91:1 shift, 3.20:1 throttle mechanical advantage.



MOR306950	MV-2 STANDARD.....	\$ 400.99
MOR306951	MV-2 BERKELEY JET/R MOUNT.....	\$ 402.99
MOR306490	MV-2 SKI BOAT CONTROL.....	\$ 405.49
MOR35232001	RED BALL KNOB.....	\$ 8.79
MOR35232004	BLACK BALL KNOB.....	\$ 8.79

MV-3 CONTROL FOR SKI/JET BOATS

Dual function, single lever control, specially styled for today's integrated cockpit. Fits all popular outboards, inboards and stern drives. Emergency cut off feature available for most MV-3 models. Uses 33C and 33C supreme cables. Uses 40 series cables for Berkeley jet and Mercury 175 HP jet.

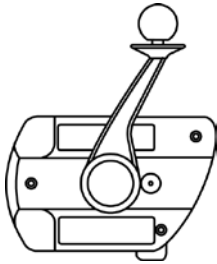

MOR311364	MV-3 FOR JET BOATS.....	\$ 292.99
MOR311508	MV-3 MERCURY SPORT JET (NO CUT OFF)...	\$ 377.99
MOR311412	MV-3 CONTROL BERKELEY RT HAND.....	\$ 316.99
MOR311413	MV-3 LEFT MOUNT BERKELEY JET.....	\$ 316.99
MOR300928	MV NEUTRAL SWITCH KIT.....	\$ 45.99

MT-3 CONTROL

A dual function, single lever control recommended for single station applications on single and twin engine, inboards with hydraulic transmissions, outboards and I/O's. Pull out hand levers in neutral position to disengage clutch for start and warm up. Neutral safety switch to help prevent starting in gear. Crisp, positive detent lets you feel the gear selection. Built in friction drag helps prevent slippage and throttle creep. Handle and housing are heavily chrome plated for extra corrosion resistance. Adjustable shift travel. Uses 33C or 33C supreme cables. 2.77 : 1 Shift, 3.57 : 1 Throttle, mechanical advantage.

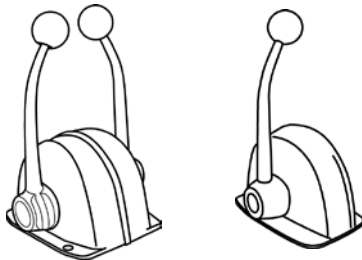

MOR308601	MT-3 SINGLE.....	\$ 390.99
MOR308602	MT-3 TWIN W/NEUTRAL SWITCH.....	\$ 714.49
MOR35232001	BALL KNOB, RED.....	\$ 8.79
MOR308742	H.D. CONV. KIT(SINGLE ONLY), MT-3.....	\$ 87.99

SL-3 CONTROL

A dual function, single lever control with a perfect match to any engine, outboard, inboard or sterndrive. Use on Evinrude, Johnson, Honda, Mariner, Mercury, Nissan, OMC, Cobra, Suzuki, Tohatsu, US Marine/Force, Volvo, Yamaha. Port or starboard installation with various cable entry angles. Firm yet effortless shift and throttle motion. Entire mechanism enclosed and permanently lubricated. Easy on cable design. no adjustments - no modifications. Push button for neutral engine warm up. Trim switch in handle grip for one hand operation. Neutral interlock prevents starting in gear. Adjustable brake prevents throttle creep. Mechanical advantage 2.38 : 1. Accepts Mercury(KM), OMC(O,OS), (33C/Supreme) cables.

MOR309473	SIDE MOUNT STANDARD W/OUT SWITCH.....	\$ 323.99
MOR309474	SIDE MOUNT DLX W/TRIM SWITCH.....	\$ 375.99
MOR309475001	SIDE MOUNT DELUXE W/TRIM AND TILT SWITCHES (VOLVO).....	\$ 512.49
MOR309475002	SIDE MOUNT DELUXE WITH TRIM AND TILT SWITCHES.....	\$ 467.99
MOR309476	TOP MOUNT SINGLE - STANDARD.....	\$ 365.49
MOR309477	TOP MOUNT SINGLE DELUXE WITH TRIM SWITCH.....	\$ 415.99
MOR309478001	TOP MOUNT SINGLE DELUXE WITH TRIM AND TILT SWITCHES (VOLVO).....	\$ 532.99
MOR309478002	TOP MOUNT SINGLE DELUXE WITH TRIM AND TILT SWITCHES.....	\$ 486.99
MOR309479	TOP MOUNT TWIN - STANDARD.....	\$ 698.49
MOR309480	TOP MOUNT TWIN DELUXE WITH TRIM SWITCH.....	\$ 784.99
MOR309481	TOP MOUNT TWIN DELUXE WITH..... TRIM AND TILT SWITCHES..	\$ 857.49
MOR315590	OPTIONAL TRIM SWITCH KIT.....	\$ 8.39

"S" & "TWIN S" CONTROL

A single function with one or two lever control for use on motor yachts with I/O's or inboards with hydraulic transmissions. Provides operation of throttle or clutch on single (S) or twin (TWIN S) engines. Easily adapts to multiple stations.

- Adjustable brakes and stops. Heavy chrome plated. Heavy duty kit for use with 43C cables. Optional neutral safety switch to prevent starting in gear. Optional gear detent for dual stations. 2.77 : 1 Shift and 2.77 : 1 Throttle mechanical advantage. Optional throttle hold kit prevents throttle creep. Uses 33C, 33C Supreme and 43C cables.

MOR31001001	TWIN S CONTROL.....	\$ 290.99
MOR31002001	SINGLE S CONTROL.....	\$ 258.99
MOR35232001	BALL KNOB, RED.....	\$ 8.79
MOR35232004	BALL KNOB, BLACK.....	\$ 8.79

"S" CONTROL CLUTCH DETENT KIT

MOR22328	CLUTCH DETENT KIT.....	\$ 25.49
----------	------------------------	----------

DUAL STATION TRANSFER UNIT

Ideal for parallel dual station installations when two-lever single function controls are used. The transfer unit allows two clutch or two throttle cables to be connected to a single cable leading aft to the engine. These units are recommended for installations with long or difficult cable paths to eliminate undesirable cable bends that cause cable backlash and reduced efficiency.

MOR61371	TRANSFER UNIT.....	\$ 248.99
----------	--------------------	-----------

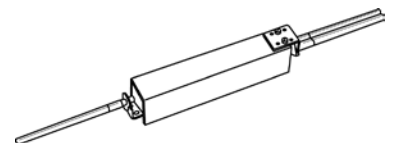
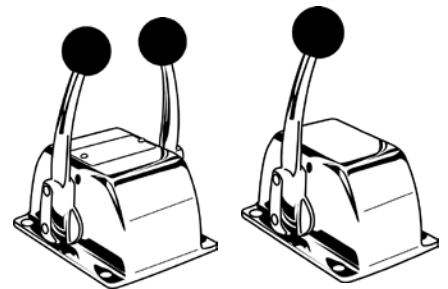
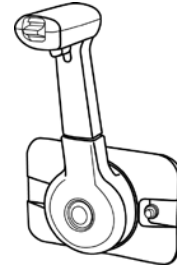



TWIN SR CONTROLS

The SR control is a two lever control used on major yachts with I/O's or inboards with hydraulic transmissions. The SR provides operation of throttle on a (TWIN SR) engine. Easily adapts to multiple stations. Easy to install and low maintenance. Adjustable brakes and stops. Heavy duty kit for use with 43C cables. Optional neutral safety switch to prevent starting in gear. 3.10 : 1 Shift and 3.10 : 1 Throttle mechanical advantage.
 - Uses 33C, 33C Supreme or 43C heavy duty cables.

MOR36469001	SR TWIN CONTROL	\$ 357.49
MOR35232001	BALL KNOB, RED	\$ 8.79
MOR35232004	BALL KNOB, BLACK	\$ 8.79



"ST" AND "STB" (BRAKE) CONTROL

A single function, one lever economical, durable throttle control. Has a heavy chrome finish. The STB control has a throttle brake and can be used to shift Berkley jets when foot throttle is used. 3.20 : 1 mechanical advantage.

MOR31791	ST 30 SERIES CABLES	\$ 114.99
MOR39115	ST-HD 40 SERIES CABLES	\$ 119.99
MOR35232004	BALL KNOB, BLACK	\$ 8.79
MOR44386	THROTTLE CABLE BRAKE	\$ 22.99

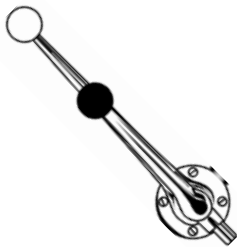

"MJB" CONTROL

A single function, two lever control for shift and throttle on sailboats. External adjustable throttle brake to avoid throttle creep and overcome governor back pressure. Optional neutral safety switch to avoid starting in gear. 3.63 : 1 Shift and 3.20 : 1 Throttle mechanical advantage. Uses 33C, 33C Supreme or 64BCXL cables.

MOR44716001	MJB CONTROL	\$ 569.49
MOR35232004	BALL KNOB, BLACK	\$ 8.79
MOR44386	THROTTLE CABLE BRAKE	\$ 22.99



TELEFLEX SIDE MOUNT CONTROL

Use 3300/33C and OEM cables. Has Neutral interlock.

TEL-CH1750P	SIDE MOUNT BLACK CONTROL NO TRIM SW...	\$ 253.49
TEL-CH1751P	SIDE MOUNT BLACK CONTROL WITH TRIM SW.	\$ 309.99
TEL7206211	CUT OF SWITCH STERN IO/INBOARD	\$ 46.99
TEL7206212	CUT OF SWITCH OUTBOARD	\$ 46.99
TEL7206215	TILT SWITCH	\$ 39.99



DC CONTROL

For throttle, choke, or fuel shutdown. Also recommended for governor or valve control. Can be mounted flush on the dashboard or to the side of the wheel box.

MOR301916	(A) USE ON 33C TYPE CABLE	\$ 78.49
MOR48210	(B) MOUNTING BRACKET	\$ 45.99

UFLEX B49 TWO LEVER CONTROL BOX

Suitable for all outboard engines. Made of nylon fiberglass with anodized anticorodal levers. Left or right side mount. Standard for Mercury/Mercruiser.

UFL-B49	CONTROL	\$ 145.45
---------	---------------	-----------

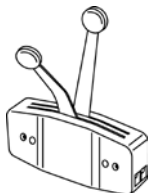

UFLEX B83 SINGLE LEVER DUAL ACTION CONTROL

A single lever, dual action side mount control box to operate both throttle and shift. Suitable for all boats with outboard, inboard or I/O's. Standard for 33C cables.

UFL-B183 CONTROL BOX\$ 215.95



TIFLEX

UFLEX B90 FLUSH MOUNT SINGLE LEVER CONTROL

Can be installed horizontally or vertically, on starboard or port side of the boat. Made of painted marine aluminum. Pull out handle disengages shift for warm up. Neutral safety switch prevents starting in gear. Provided with a positive lock-in neutral to prevent accidental gear engagement.

UFL-B90 CONTROL BOX\$ 240.95

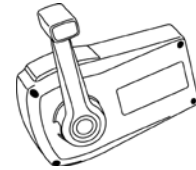

TIFLEX

UFLEX NEUTRAL SAFETY SWITCH

Single lever/dual action control to operate both the throttle and shift. Suitable for any type of outboard, inboard or I/O engine. Can be installed horizontally or vertically, port or starboard. The control lever assembly is made of painted marine aluminum. Brake tension release system that is adjustable from outside. The pullout handle disengages shift for cold engine warm up. Neutral safety switch prevents "in-gear" starts for safety. Works on all control cables except "C4" (pre 1979 OMC) & 4300 cables.

UFL-X12 NEUTRAL SAFETY SWITCH\$ 36.47



TIFLEX

UFLEX CABLE ADAPTER KITS

UFL-K23	(A) TYPE	"OS"	CABLES.....\$	14.18
UFL-K24	(B) TYPE	"O"	CABLES.....\$	29.71
UFL-K25	(C) TYPE	"33C"	CABLES.....\$	10.13
UFL-K35	(D) TYPE	"MERCURY"	CABLES.....\$	17.56

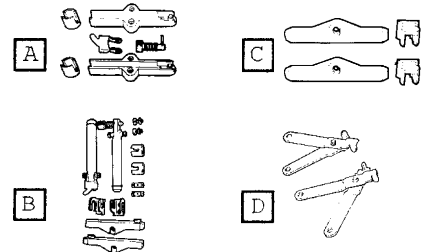

TELEFLEX PRO TRIM STEERING WHEEL CONTROL

Controls either engine trim, jack plate or horn. Mounts behind steering wheel, simple and clean with no holes in the floor. Comes in either single or dual switch to control one or two functions. Includes switch assembly, function decals, wiring, mounting hardware and instructions.

TEL-PT1000P	SINGLE SWITCH - ONE SIDE.....\$	79.49	G
TEL-PT2000P	DOUBLE SWITCH-BOTH SIDES.....\$	111.49	G

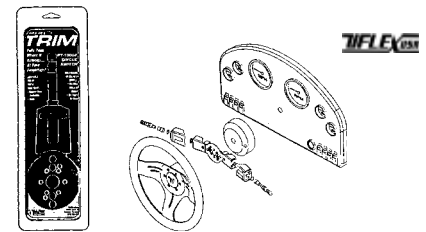

TIFLEX

T-H STEERING TRIM CONTROL UNIT

This weatherproof switch mounts easily to your steering wheel spokes to place engine trim control at your fingertips. Includes black urethane coiled cord.

TNH-ST1 TRIM CONTROL\$ 51.95

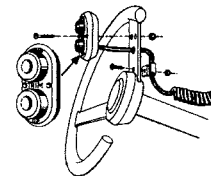

Marine

T-H TRANSOM TRIM CONTROL

Works great for placing motor support in position. Weather proof.

TNH-TTC1 TRANSOM TRIM CONTROL\$ 37.95

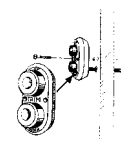

Marine

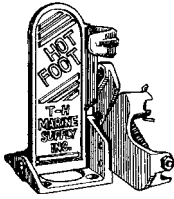

T-H HOT-FOOT THROTTLE

The original foot throttle. Aluminum casting with S.S. spring and hardware.

TNH-HF1	OMC / MERC / MARINER	\$ 123.95
TNH-HF1CT-DP	YAMAHA / CHRYSLER	\$ 149.95
TNH-HFS1	REPLACEMENT SPRING	\$ 9.79

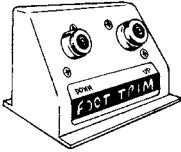

T-H HOT TRIM FOOT CONTROL

Floor mounted trim is an excellent safety item in boat performance accessories. Black matte unit comes prewired with instructions.

TNH-HT1	HOT TRIM	\$ 51.95
---------	----------------	----------