

THETFORD PORTA-POTTI

This self-contained portable head is a simple, inexpensive alternative to a permanent marine head installation. Fresh water is held in the upper tank, while waste is stored in the lower tank. Simply detach the lower tank when full and dispose at any shoreside facility. A built in pour spout reduces splatters. Includes storage for waste tank chemical bottle.

- #25103 = 15 1/16" L x 13 9/16" W x 12 1/8" H 2.6 GAL FRESH 2.6 GAL HOLDING
- #28527 = 17 1/8" L x 15 1/8" W x 15 15/16" H 3.2 GAL FRESH 6.1 GAL HOLDING
- #25104 = 15 1/16" L x 13 9/16" W x 12 1/8" H 2.6 GAL FRESH 2.6 GAL HOLDING
- #25105 = 15 1/16" L x 13 9/16" W x 12 1/8" H 2.6 GAL FRESH 2.6 GAL HOLDING

THF25103	135 PARCH.....	\$ 129.49
THF28527	565 PARCH.....	\$ 185.95 *
THF25104	735 PARCH/GREY.....	\$ 167.49
THF25105	735 PARCH/GREY MSD WITH PUMP OUT	\$ 191.99
THF14900	HOLD DOWN KIT.....	\$ 22.50



THETFORD 345 TOILET

High gloss, easy to clean finish. Exclusive, no splash pour out spout . Built-in deodorant storage compartment. Waste holding tank level indicator. 4.0 fresh water. 3.2 gallon Waste Tank. Dimension: 13.4"H x 15"W x 16-1/2"L .

THF25113	PORTA-POTTI	\$ 172.49
----------	-------------------	-----------



THETFORD 365 MSD TOILET

Exclusive No-Spill Vent Cap prevents spills. Exclusive, self-storing, rotating Pour-Out Spout makes emptying easy. Push-button Air Relief Valve allows quick, clean tank evacuation Includes Latch and Lever Indicators. Dimensions: 16-15/16"L x 15-1/8"W x 15-15/16"H .

THF25109	PORTA-POTTI	\$ 215.00
----------	-------------------	-----------



THETFORD AQUA-MATE 885 MSD ELECTRIC TOILET

The industry's premium portable and Type III Marine Heads, AquaMate 885 models feature an easy-to-operate, battery-operated (six AA-cells) push-button flush which offers a superior bowl washdown. Aquamate MSD Marine Head with a tall profile and sturdy base supporting a comfortable seat, the Aquamate series offers superior comfort and convenience. The 6.1 gallon holding tank gives more uses before emptying than most other portable heads - an average of 62 flushes! Level gauge turns from green to red, telling you when it's time to empty the tank. These units also feature a built-in toilet tissue dispenser. Specially designed hold-down brackets secure the head to the floor or deck. Constructed of lightweight, high impact, high-gloss polypropylene for easy maintenance, good looks and durability. 15 1/8 inches Wide X 15-15/16 inches High X 19 inches L. 3.2 gallon freshwater tank. Parchment color.

THF25110	885 MSD ELECTRIC FLUSH TOILET.....	\$ 229.00
----------	------------------------------------	-----------



THETFORD AQUA-SOFT TISSUE 2-PLY

For use in all RV and Marine permanent, recirculating & portable toilets. Now packed in a reusable plastic bag. Specially-formulated, rapid dissolving tissue. Helps prevent messy clogs. Flushes easily from bowl. Soft, snowy-white tissue. Biodegradable. Four rolls per package. Deluxe 2 ply tissue, 500 sheets/roll

THF03300	AQUA SOFT 2 PLY 4 PK TISSUE.....	\$ 7.19
----------	----------------------------------	---------





THETFORD RV/MARINE TISSUE 1-PLY

MARINE SOFT RAPID DISSOLVE TOILET TISSUE is an economical single ply tissue that won't clog drains. For use in all Marine and RV portable, permanent and recirculating sanitation systems. Specially formulated, rapidly dissolving tissue is soft and strong, and flushes easily from bowl. Help prevent messy clogs. 100% biodegradable. 350 sheets per roll, four (1 ply) rolls per pack.

THF20804 RV/MARINE 1PLY TISSUE\$ 4.19



WALEX HAND SANITIZER

Fragrance Free. No Rinsing or Wiping required. Moisturizes w/ Aloe & Vitamin E. Keeps hands clean when water is not available. Kills 99.9% of most common disease-causing germs.

WLX-OTH20036 2 OZ BOTTLE HAND SANITIZER\$ 1.79



THETFORD AQUA-KEM HOLDING TANK DEODORANTS

An RV's toilet is located over, and empties directly into, the Black Water Holding Tank. The three most common Black Water Holding Tank problems are deodorizing, cleaning and breakdown of solid waste. Thetford deodorants outsell their competitors combined because they do a superior job in these three problem areas.

THF09852 AQUA-KEM 32OZ CAN TOSS INS DEODRANT...\$ 10.99
 THF20720 AQUA-KEM 8 20Z TOSS INS PER CAN.....\$ 12.99
 THF24453 AQUA-KEM 3 80Z BOTTLES.....\$ 9.59
 THF24821 AQUA-KEM 6 80Z BOTTLES.....\$ 17.99
 THF28614 AQUA-KEM 1 GALLON BOTTLE.....\$ 35.49
 THF36535 AQUA-KEM DROP IN TABLETS 10 PK.....\$ 17.79



THETFORD SUPREME GREEN

Formaldehyde-free holding tank deodorant. For use in all marine & RV portable, permanent, and recirculating systems. Powerful all-season odor control, faster waste and tissue breakdown. 100% diodegradable liquid, only 4 oz. per gallon tank. New dose bottle makes it easy to measure and pour exactly the right amount every time.

THF28736 36 OZ BOTTLE.....\$ 16.25 *
 THF36543 128 OZ BOTTLE.....\$ 41.50 *
 THF36530 12PK OF DISSOLVABLE PACKS\$ 12.75 *



THETFORD SUPREME GREEN DRY

Formaldehyde-free holding tank deodorant. For use in all marine & RV portable, permanent, and recirculating systems. Powerful all-season odor control, faster waste and tissue breakdown. 100% diodegradable non-dusting powder in easy-to-use packets. 8-2 oz. packets/box.

THF28774 8 2-OZ PACKS.....\$ 14.50



THETFORD TISSUE DIGESTER

Prevents tissue build-up in the black water tank and drain lines. Breaks down toilet tissue in tanks. Helps relieve a tissue-clogged line. Keeps drain lines clean and free-flowing.

THF15844 16 OZ BOTTLE.....\$ 12.39

THETFORD GREY-WATER CONTROL

Thetford Grey Water Odor Control solves holding tank problems. Non-staining, formaldehyde-free and environmentally safe. 5 oz./40 gal. tank. USA.

THF15842 30 OZ GREY-WATER CONTROL.....\$ 7.59



THETFORD DRAIN VALVE LUBE

Prevents sticky valves, restores smooth operation, and coats plumbing lines for consistent tank outflow. 100% biodegradable.

THF15843 20 OZ BOTTLE LUBE.....\$ 8.59



WALEX EXODOR PORTA-PAK

Exodor formaldehyde-free deodorizers are the only products delivering a complex formulation of ingredients working both independently and in unison to control odors as the waste load increases.

WLX1090200 PORTA-PAK (250 PER CASE).....\$ 196.35
 WLX-PORTAPAK PORTA PAK (10 PACK).....\$ 10.95



WALEX BIO-PAK NATURAL ENZYME HOLDING TANK DEODORIZER & WASTE DIGESTER

Bio-Pak deodorizing packets are the result of the Walex R&D Group's extensive research into discovering new, highly effective natural enzymes to control odor and liquefy waste. Starts working immediately to control odors. Rapidly breaks down waste & paper. Environmentally friendly. Non-staining color. New fresh scent. California Waste Water Approved.

WLX-BIOPACK BIO-PAK (250 PER CASE).....\$ 205.30
 WLX-BIO-PAK BIO-PAK (10 PACK).....\$ 12.75



WALEX SUPER SIZE DEODORANT DISCS

Designed to Last Longer and Smell Better! Place a disc on the provided self-adhering hook. Conceal it on the back side of the vent pipe, or place disc on the outside end of the toilet paper rod, behind the urinal, cabinet, or trash receptacle.

WLX-DISCBUB BUBBLE GUM SCENT 100 PK.....\$ 45.25
 WLX-DISCFANTASY FANTASY SCENT 100 PK.....\$ 45.25
 WLX-DISCVBE VERY BERRY SCENT 100 PK.....\$ 45.25
 WLX-SUNGLOW SUN GLOW SCENT 100PK.....\$ 45.25



CRC MARINE HEADS UP™ LIQUID HOLDING TANK DEODORANT

Works instantly to control odors. Long lasting pleasant fragrance. Helps keep holding tanks and recirculating and portable toilets clean and breaks down waste and tissue. Non-formaldehyde formula.

CRC-MK4524 (QTY: 3) 8 OUNCE BOTTLES.....\$ 14.95
 CRC-MK4532 32 OUNCE BOTTLE.....\$ 14.95



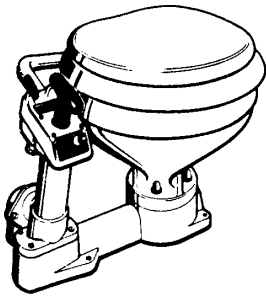

JABSCO PAR MANUAL MARINE TOILET

While they were designed primarily for ease of operation and user convenience, the need for a clean, uncluttered appearance was never overlooked. If desired, the pump and base can be assembled for left hand installation. The base assembly is fully skirted to eliminate the debris traps associated with most other toilets. Compact bowl size.

JAB29090-3000	16-3/4"D X 17-3/4"W X 13-3/16"H.....	\$ 230.00
JAB29040-2000	REPLACEMENT PUMP 2007 AND BELOW.....	\$ 139.95
JAB29040-3000	REPLACEMENT PUMP 2008 AND UP.....	\$ 91.95
JAB29045-3000	MAJOR SERVICE KIT 2008 AND UP.....	\$ 73.95
JAB29045-2000	MAJOR SERVICE KIT 1997 & 2007.....	\$ 73.95
JAB59127-7050	PUMP ASSEM. ELBOW & JOKER VALV.....	\$ 234.00

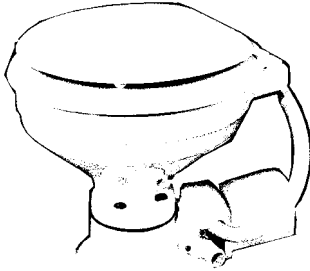

JABSCO PAR ELECTRIC MARINE TOILET

The electric toilet is equipped with a dual function pump. The self-priming flush pump rinses the bowl as the macerator and high capacity scavenger pump grinds up waste and pumps it out. Included with the toilet is a heavy duty push-button switch and 1" to 1-1/2" hose adaptor for the discharge hose. Inlet 3/4". Outlet 1".

JAB37010-0090	12VDC 13-3/4"H 13-7/8"W 17-5/8"L.....	\$ 574.00
JAB37040-0000	SEAL & GASKET SERVICE KIT.....	\$ 61.95

JABSCO TOILET BASE ASSEMBLY

Base includes phillips head screws, starlock washers, hex nuts, plastic washers, stainless steel washers, nut caps, joker valve, 1" discharge port and discharge port screws.

JAB37004-1000	USE ON 37010,37045,37075 SERIES.....	\$ 130.95
---------------	--------------------------------------	-----------

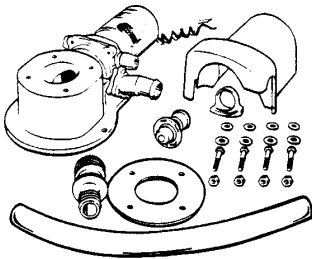

JABSCO ELECTRIC TOILET CONVERSION KIT

Converting a manual marine toilet to simple push button electric operation is easy with the PAR toilet conversion kit. It can be fitted with the Raritan P.H. or Compact, Wilcox Crittenden "Head Mate", Groco HC, Sealand (Mansfield) 750 Series, PAR or Brydon 59128- Series, or PAR 29090/29120 Series, and virtually any other marine toilet using 3-3/4" diameter bolt circle with a 4-hole pattern base. A built in backflow preventer is included in discharge. A heavy duty push-button switch and 1" to 1-1/2" hose adaptor for the discharge port and all clamps and fasteners to complete the conversion are included. Inlet 3/4", discharge 1".

JAB37010-0092	12V ELECT. CONVERSION KIT.....	\$ 517.00
JAB37040-0000	SEAL & GASKET SERVICE KIT.....	\$ 61.95

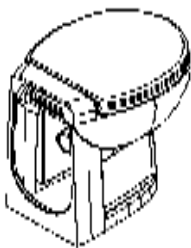

TECMA SILENCE TOILETS

The Tecma silence series of marine toilets offer a winning combination of sleek European styling and exceptionally reliable performance. Solid porcelain bowl and stand. Sits flush against back wall. Automatic function cycle. High-performance centrifugal pump. Intake inside diameter 3/4". Discharge inside diameter - 1-1/2". Seat height - 17-3/4" Width - 14-3/8" Depth - 17"-7/10"

TMA38097	SILENCE TOILET STANDARD 12V WHITE.....	\$1238.00	G
----------	--	-----------	---

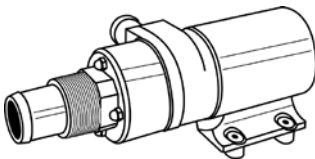

JABSCO MACERATOR PUMPS

RUN-DRY MACERATOR PUMP. The Jabsco Macerator pump unit is the ideal answer to holding tank pump out problems for boats and recreational vehicles. Run-dry protection electronics makes impeller damage a thing of the past. Detects the absence of fluid then shuts-off pump before impeller is damaged. Sensor provides a 16 - 20 second run-dry period to allow initial priming of pump. Interrupting power supply to the macerator resets the Run-Dry Device. Flow rate to 12 gpm (45 lpm). Self-priming to 4ft (1.2m) vertical lift. Complies with USCG 183.410 and ISO 8846 MARINE (Ignition Protection).
 Marine Model: Inlet port 1 1/2" (38mm) hose barb plus 1 1/2" NPT 0257-0189 18590-1000 RV Model: Inlet port 3" (75mm) hose. Discharge port: 1" (25mm) hose.

	VOLTS	GPM	DIMENSIONS HEIGHT/WIDTH/LENGTH	
JAB18590-2092	12	12	3-3/8"X 4-5/8"X10-3/8"	...\$ 218.00

JABSCO MACERATOR PUMP

Push button, self-priming flush pump rinses bowl as macerator & high capacity scavenger pump grinds up & pumps out waste. Includes heavy-duty push-button switch & 1" to 1-1/2" hose adapter for discharge hose. Inlet 3/4". Outlet 1". 12V Yacht size: for all vessels & pleasure yachts where space is not critical, larger bowl toilet & household-type seat & lid. 12V Standard size: dual-function pump eliminates mess w/hand pumps & dry bowl valves.



JAB37041-0010 MACERATOR PUMP\$ 278.00

JABSCO FILTERLESS WASTE PUMP

Jabco Inline Waste Evacuation Pump, 12 or 24 Volt, up to 19 litres/minute (4.2 gallons/minute) with a maximum 4m discharge head. 360° rotating pump head and ports for truly flexible installation. Capable of extensive dry running. Self-priming diaphragm waste pump Robust single diaphragm design. Handles sink, shower and black waste. Self-priming up to 3m (9.5ft) vertical lift. Rated for up to 30 minutes continuous running. 1 1/2" ports for good solids handling ability. Multi-positional ports for easy mounting. Mechanical parts shrouded for safety. No strainer required.



JAB50890-1000 1-1/2 PORTS 4.2 GPM.....\$ 336.00

SHURFLO MACERATOR PUMP

Designed specifically for sanitation waste and fish box evacuations. 12VDC. Dimensions: 10.8" x 4.5" x 3.8". Flow Rate: 13 GPM. 14 Amps. 1 -1/2" Barb Inlet, 1 -1/2" Barb Inlet, 1" Barb outlet.



SHR3200-001 MACERATOR PUMP 12V.....\$ 196.99

JOHNSON PUMPS VIKING 32 POWER

Single-chamber design and non-choke valves, the Viking Power 32, can be used to pump un-macerated sewage to a holding tank or transfer it onwards to a septic tank. The Viking Power Vacuum has double check-valves and can therefore also be used in vacuum toilet systems. Naturally, pumping ordinary shower or sink drain water or bilge water is no problem for either pump. Like the Viking Power 16, this new pump has been engineered with a ball-bearing supported transmission for long service life. The pump can not only be run dry, it can also handle a mixture of air and water without difficulty. Vacuum provides maximum flow of 32 liters per minute and is self-priming up to a height of 2.5 (32) or 3.5 (Vacuum) meters. Although powered by an electric motor, this pump can also be cranked by hand in an emergency. The pump has been designed to prevent the leakage of unpleasant odors. Vacuum can be installed in a variety of different positions.



JPA10-13373-03 8.5 GPM.....\$ 380.00

JOHNSON PUMPS TA3P10-19 MACERATOR

Ignition protected motor, conforming with ISO 8846 Marine. Mounting bracket for easy replacement. Rotary cutter of PET (thermoplastic polyester). Directly connected to sewage line or holding tank. Features: Pump body: Phenol plastic (PF). Impeller: Nitrile Cutter casing: Thermoplastic polyester (PET). Shaft: Stainless steel. Seal: Lip seal Voltage:12V Hose connection: Inlet 1 1/2" Outlet 1" hose 9.06"L X 4.25"W X 3.23"H



JPA10-24453-01 MARCERATOR PUMP 12V.....\$ 155.95

JABSCO 45490-1000 Y-VALVE

The Jabsco Y-Valve diverts waste from a toilet to either an onboard holding tank or directly overboard where legal to do so. It can be used to direct waste from a holding tank to either an onboard discharge pump or a deck waste fitting for dockside pumpout. Its self cleaning design provides trouble free operation. Has a large easy to turn handle with integral locking ring that allows it to be locked or sealed in either position. The 1-1/2" curved discharge ports can be rotated through 360 degrees so the discharge hoses can be routed away in parallel, at 90 degrees to each other. It is supplied with both a 1-1/2" (fitted) and 1" straight inlet port for easy attachment to toilets with 1" discharge hoses.

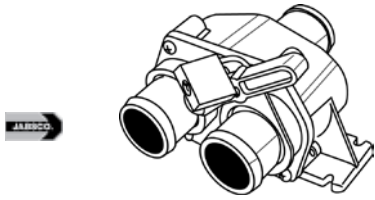

JAB45490-1000 JABSCO Y-VALVE\$ 76.95

SEALAND NOZ-ALL PUMPOUT ADAPTER

The Sealand Noz-All pumpout adapter provides an airtight seal between your boat's deck waste fitting and the pump-out station nozzle. An airtight seal ensures thorough emptying of waste holding tanks. The Noz All is available in different thread sizes and diameters to fit multiple thru-hull dimensions, and adapter end is tapered to seal tightly with pump-out nozzle assemblies.

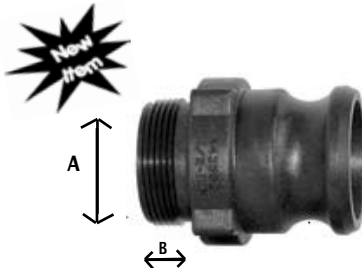

SLD310343502 (A)=1-7/8" (B)=2-3/4 THREAD PER 1/4" ..\$ 23.02
 SLD310343503 (A)=1-5/8" (B)=2-3/4 THREAD PER 1/4" ..\$ 23.02
 SLD310343504 (A)=1-5/8" (B)=4 THREAD PER 1/4" ..\$ 23.02

PERKO FIG. 1269 WASTE DECK PLATE FOR HOSE

Complete with Fig. No. 1248 Key and O-Ring. Cap has a slot between the holes. For 1-1/2" hose. Outside diameter is 3-1/2".



PK01269-DP-CHR WASTE DECK PLATE\$ 40.49
 PK01269-DP-99A SPARE CAP & O-RING.....\$ 12.59

SEA-DOG DECK FILL - WASTE

Stamped 304 stainless.

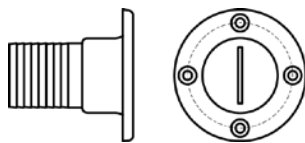

SEA351268-1 1-1/2" HOSE\$ 43.95

MOELLER WASTE/WATER TANKS

Waste tanks feature a heavier wall thickness for strength, and a 3" inspection port on larger capacity tanks for your convenience. Molded of FDA approved linear polyethylene which meets the CFR 177.1520 criteria.

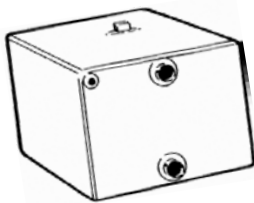

MOE41206 5 GAL. 16"L X 11.75"W X 8"H.....\$ 122.95
 MOE41209 9 GAL. 17"L X 13.75"W X 10.25"H.....\$ 133.95
 MOE41311 STRAIGHT TANK FITTING.....\$ 29.95
 MOE41390 90° TANK FITTING.....\$ 34.95